

Submittal Data

ASME EXPANSION TANK HEATING / AL SERIES

Job Name: _____
 Location: _____
 Engineer: _____
 Contractor: _____
 Sales Rep.: _____

Submitted by: _____ Date: _____
 Approved by: _____ Date: _____
 Order No.: _____ Date: _____
 Notes: _____

QUANTITY	<input type="text"/>	MAXIMUM PRESSURE	<input type="checkbox"/> 125 PSI / 861 kPa
MODEL	AL- <input type="text"/>		<input type="checkbox"/> 150 PSI / 1034 kPa
<input type="checkbox"/> Seismic bracket (Suffix VB)		<input type="checkbox"/> 175 PSI / 1207 kPa	<input type="checkbox"/> Other*: <input type="text"/>

*Subject to the manufacturer's approval.

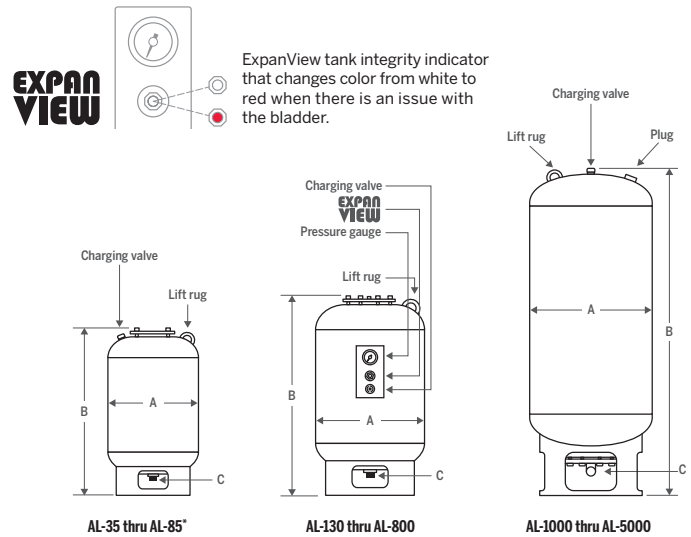

- ✔ **Replaceable bladder**
- ✔ **Bottom connection**

- ▶ Acceptance factor of 100%
- ▶ Replaceable butyl bladder
- ▶ Design conforms to ASME, section VIII
- ▶ Water remains permanently separated from air
- ▶ Air precharged at factory; pressure adjustable on site

TECHNICAL SPECIFICATIONS

- ▶ Exterior finish in painted primer
- ▶ Maximum temperature 240°F (115°C)
- ▶ Air precharged at factory at 12 PSI (83 kPa)
- ▶ Service pressure 125 PSI (862 kPa)
- ▶ Maximum pressure of 150, 175, 250 and 300 PSI also available

To obtain a tank of higher capacity and greater pressure, contact the manufacturer.



*Pressure gauge available as an option.

Model#	Volume		Dimensions				NPT Connect.		Weight	
			A		B		C			
	gal	L	in	mm	in	mm	in	mm	lb	kg
AL-35	10	38	12	305	28	711	1	25	40	18
AL-50	13	50	12	305	36	918	1	25	60	27
AL-85	23	87	16	406	37	940	1	25	90	41
AL-130	35	132	20	508	37	940	1	25	125	57
AL-200	53	200	24	610	43	1092	1½	38	210	95
AL-300	79	299	24	610	55	1397	1½	38	225	102
AL-400	106	401	30	762	49	1245	1½	38	300	136
AL-500	132	500	30	762	57	1448	2	50	330	150
AL-600	158	598	30	762	65	1651	2	50	360	163
AL-800	211	798	32	813	76	1930	2	50	475	215
AL-1000	264	1000	36	914	82	2085	1¼	32	850	385
AL-1200	317	1200	36	914	94	2390	1¼	32	950	430
AL-1400	370	1400	36	914	107	2720	1¼	32	1050	475
AL-1600	422	1600	48	1220	77	1955	1½	40	1545	700
AL-2000	528	2000	48	1220	90	2290	1½	40	1745	790
AL-2500	660	2500	48	1220	108	2760	2	50	1965	890
AL-3000L	792	3000	48	1220	125	3175	2	50	2200	995
AL-3000S	792	3000	60	1524	91	2310	2	50	2700	1220
AL-4000	1056	4000	60	1524	115	2920	2½	65	3150	1425
AL-5000	1320	5000	60	1524	137	3480	2½	65	3600	1630

TYPICAL SPECIFICATIONS

Furnish and install, as shown on the plans, a _____ gallons/liters _____ in/mm diameter × _____ in/mm (high) air precharged steel expansion tank, with a heavy duty butyl replaceable bladder. The tank shall have a _____ in/mm bottom NPT stainless steel system connection and a 0.302"-32 charging valve (standard tire valve) to facilitate the on-site charging of the tank to meet system requirements. The tank shall be fitted with lifting rings and basering or angle legs for vertical installation. The tank must be constructed in accordance with Section VIII of the ASME Boiler and Pressure Vessel Code and stamped _____ PSI working pressure. Each tank shall be Expanflex model AL-_____ or approved equal.